

PIN	DIM, A	DIM, B	DIM, C	DIM, D
04	8.0	6.8	1.50	2.6
05	8.5	7.3	2.00	3.1
06	9.0	7.8	2.50	3.6
07	9.5	8.3	3.00	4.1
08	10.0	8.8	3.50	4.6
09	10.5	9.3	4.00	5.1
10	11.0	9.8	4.50	5.6
11	11.5	10.3	5.00	6.1
12	12.0	10.8	5.50	6.6
13	12.5	11.3	6.00	7.1
14	13.0	11.8	6.50	7.6
15	13.5	12.3	7.00	8.1
16	14.0	12.8	7.50	8.6
17	14.5	13.3	8.00	9.1
18	15.0	13.8	8.50	9.6
19	15.5	14.3	9.00	10.1
20	16.0	14.8	9.50	10.6
21	16.5	15.3	10.00	11.1
22	17.0	15.8	10.50	11.6
23	17.5	16.3	11.00	12.1
24	18.0	16.8	11.50	12.6
25	18.5	17.3	12.00	13.1
26	19.0	17.8	12.50	13.6
27	19.5	18.3	13.00	14.1
28	20.0	18.8	13.50	14.6
29	20.5	19.3	14.00	15.1
30	21.0	19.8	14.50	15.6
31	21.5	20.3	15.00	16.1
32	22.0	20.8	15.50	16.6
33	22.5	21.3	16.00	17.1
34	23.0	21.8	16.50	17.6
35	23.5	22.3	17.00	18.1
36	24.0	22.8	17.50	18.6
37	24.5	23.3	18.00	19.1
38	25.0	23.8	18.50	19.6
39	25.5	24.3	19.00	20.1
40	26.0	24.8	19.50	20.6
41	26.5	25.3	20.00	21.1
42	27.0	25.8	20.50	21.6
43	27.5	26.3	21.00	22.1
44	28.0	26.8	21.50	22.6
45	28.5	27.3	22.00	23.1
46	29.0	27.8	22.50	23.6
47	29.5	28.3	23.00	24.1
48	30.0	28.8	23.50	24.6
49	30.5	29.3	24.00	25.1
50	31.0	29.8	24.50	25.6
51	31.5	30.3	25.00	26.1
52	32.0	30.8	25.50	26.6
53	32.5	31.3	26.00	27.1
54	33.0	31.8	26.50	27.6
55	33.5	32.3	27.00	28.1
56	34.0	32.8	27.50	28.6
57	34.5	33.3	28.00	29.1
58	35.0	33.8	28.50	29.6
59	35.5	34.3	29.00	30.1
60	36.0	34.8	29.50	30.6

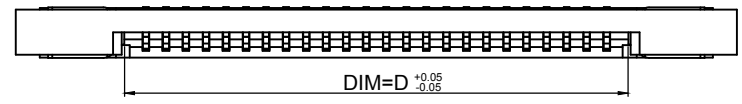

Electrical Characteristics:
 Current rating: 0.4A AC/DC
 Voltage rating: 50V AC/DC
 Temperature range: -25°C~+85°C
 Withstand Voltage: 200V AC/Minute
 Contact Resistance: ≤ 20mΩ
 Insulation resistance: ≥ 500MΩ
 Relative Humidity: 93%+40°C

Material Description:
 Terminal: Phosphor Bronze Tin-Leadplated
 Fitting Nail: Brass Tin-plated
 Housing: Thermoplastic(UL94V-0)
 Slider: Thermoplastic(UL94V-0)

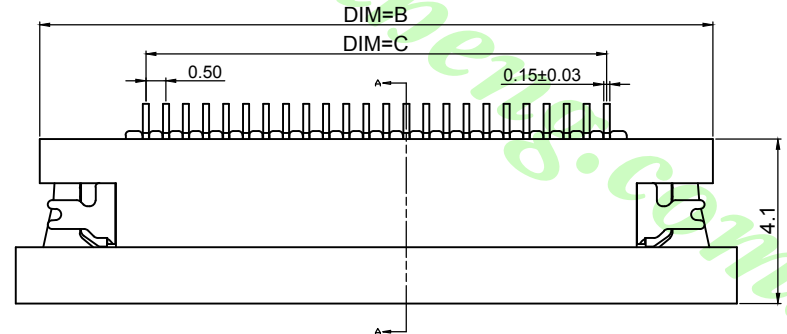
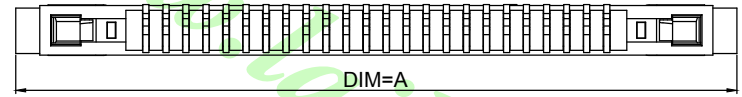
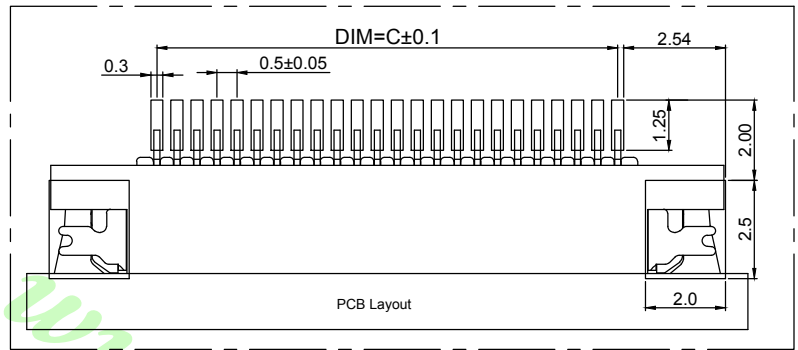
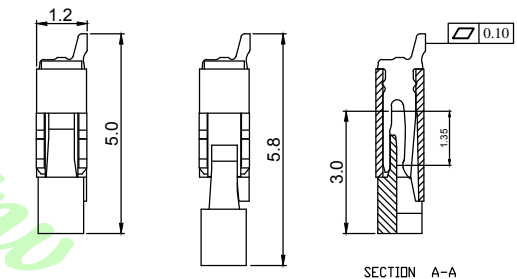
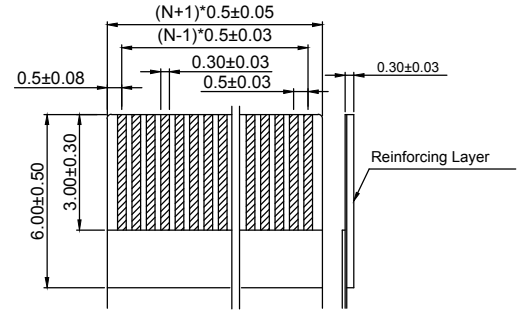

SERIES NO. LFPC-K825 CONTACT TYPE B Pin no. XX CONTACT PLATING PT PACKAGE 2
 FPC 0.5 pitch ZIF R/A SMT CONN. B: Bottom contact 04~60 PT: PURE TIN 1:Tube 2:T&R
 G1: Gold Flash

A0 NEW DRAWING 2018.06.18		公認/UNLESS OTHERWISE SPECIFIED TOLERANCES ARE	單位/Unit mm	品名/Title : FPC 0.5mm Pitch ZIF SMT R/A 1.2H Bottom contact conn.
REV	概述/REVISION	日期/DATE	比例/Scale	料號/Part No : LFPC-K825-B-XX-XX-X
			Free Size A4	圖號/Drawing No :

鍊亨電子有限公司
 LAI HENG TECHNOLOGY LTD.
 TEL:(02) 8228-6487 FAX:(02) 8228-6486

核加/APPD. 7/0 審核/CHKD. Joe 製圖/DR. Mandy 裝數/Sheet 1 of 1